



Gate Valve

Description
 Bolted Bonnet
 Outside Screw and Yoke
 Solid Wedge for 15A - 50A (1 1/2" - 2")
 Flexible Wedge for 65A - 300A (2-1/2" - 12")
 Rising Stem
 Non-rising Handwheel
 Integral Seat Ring for API 603
 RF End
 Seat Ring Stellite for API 600

Pressure Class:
 ANSI 150# - 2500#
 JIS 10K
 DIN PN16
 Size: 1/2" - 24" (15A - 600A)

Stainless Steel / Carbon Steel / Ductile Iron
 Other materials available on request

API-598 Test Standard



Globe Valve

Description
 Bolted Bonnet
 Outside Screw and Yoke
 Rising Stem and Handwheel
 Yoke Integral with Bonnet
 Integral Seat Ring for API 603
 Loose Disc
 RF End
 Seat Ring Stellite for API 600

Pressure Class:
 ANSI 150# - 2500#
 JIS 10K
 DIN PN16
 Size: 1/2" - 24" (15A - 600A)

Stainless Steel / Carbon Steel / Ductile Iron
 Other materials available on request

API-598 Test Standard



Trunnion Ball Valve API 6D

ANSI 150# - 2500#
 Fire Safe to API 607 / API 6FA
 Ends: Flanged End, Butt Weld End
 Anti-Static Device
 Blow-out-proof Stem
 Full Port / Reduced Port
 Body: A105, LF2, F316, F316L, F51, F53
 Size: 2" (DN50) - 24" (DN600)
 Lever Operate, Gear Operate,
 Pneumatic Actuator Operate

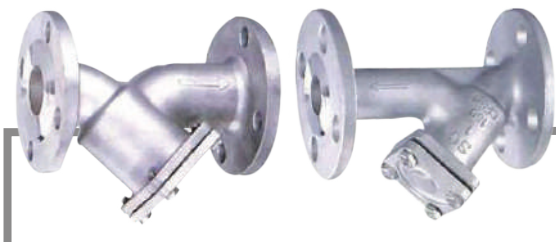

Y-Strainer Valve

Pressure Class:
 ANSI 150#
 JIS 10K
 DIN PN16
 Size: 1/2" - 12" (15A - 300A)
 End Connection: RF End

Stainless Steel / Carbon Steel / Ductile Iron
 Other materials available on request

API-598 Test Standard

Ichinose Emico Valves (S) Pte Ltd (IEVS) provides high quality valves and fluid control solutions to all our clients in the Asia Pacific Region and other markets all around the world. With vast experience and expertise of our manufacturing principals, our valve brands have obtained various International Quality Assurance System such as ISO 9001, PED CE, API 6D and product certifications which include API 607 Fire Safe Approval, AGA Gas Approval, Fugitive Emission Test, ABS and DNV - GL Marine Classification. As one of the biggest OEM valve casting manufacturer in Asia, our mills (100% owned) and foundries are currently producing GATE, GLOBE, CHECK, BALL & BUTTERFLY, whereby some of our clients (Eg, ExxonMobil, Pertamina, PTT Group, Petronas, CTCI Corp, Formosa Corp, Toyo Engineering, etc.) has approved and recognised our trademark and quality.

IEVS is our first Regional Sales Office and Distribution Centre with an over 60,000 m² warehousing facility, keeping an array range of various valve products and as well as other Stainless / Carbon Steel Pipes, Fittings and Flanges in Singapore. In order to increase our product range and services, IEVS is also supplying Penstocks, Sluice Gates, Stop Logs and cooperate with many international actuator partners to provide a complete automated solution packages to our clients.

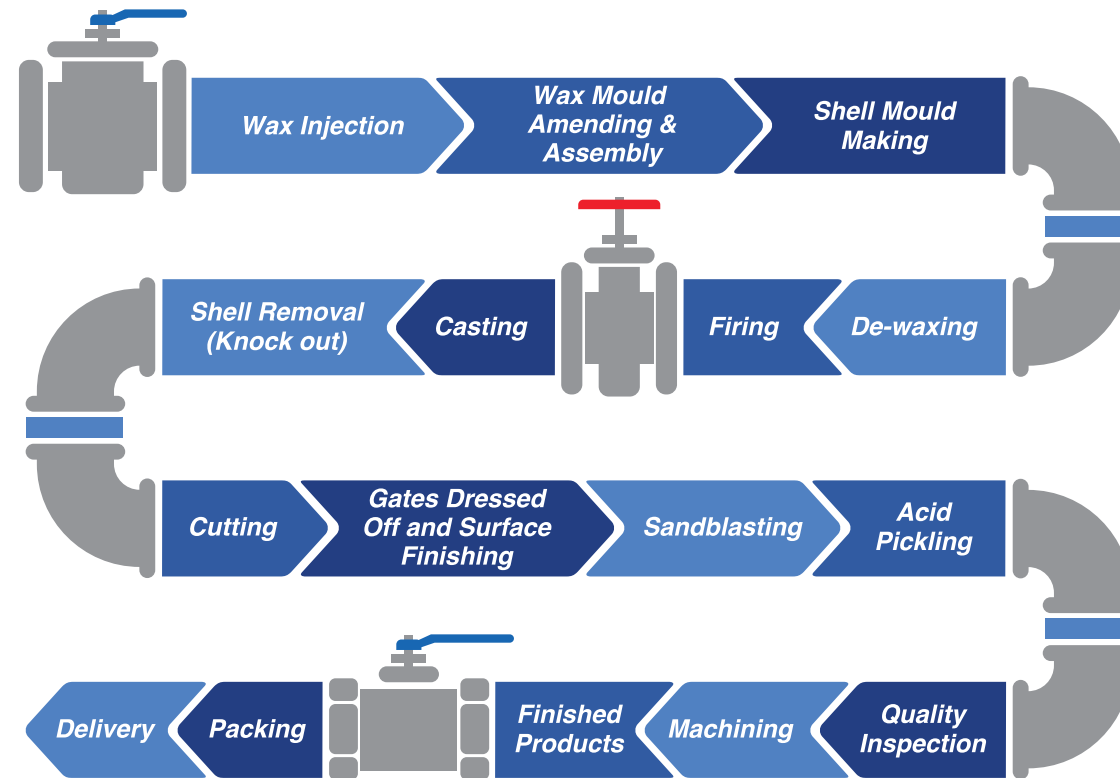

OUR SOLUTIONS

VALVE TYPES

- BALL (FLOATING, TRUNNION)
- GATE / GLOBE / CHECK
- Y-STRAINER / KNIFE GATE
- BUTTERFLY
- CRYOGENIC
- STOP LOG
- PENSTOCK / SLUICE GATE

INDUSTRIES

- UPSTREAM / DOWNSTREAM
- OIL & GAS / REFINERY
- POWER / ENERGY / LNG
- MARINE / OFFSHORE
- CHEMICAL / PETROCHEMICAL
- WATER / WASTE TREATMENT
- PULP & PAPER / MINING

SERVICES - VALVE AUTOMATION (PNEUMATIC / ELECTRIC)

ICHINOSE CO. LTD

1-9-1, Chiyozaki, Nishi-Ku,
 Osaka, 550-0023, Japan
 Tel: +81-6-6582-5115

EAYUAN METAL INDUSTRIAL CO., LTD.

16F-8, No.386, Shizheng Rd.,
 Xitun Dist, Taichung City 407, Taiwan
 Tel: 886-4-2259 1616

ICHINOSE EMICO VALVES (S) PTE LTD

SOUTHEAST ASIA - SALES OFFICE
 52, Tuas Avenue 9,
 Singapore 639193
 Tel: +65 6210 2725 | Fax: +65 6861 6919
 Email: sales@ievs.co
 Website: www.ievs.co

DISTRIBUTOR:





1-PC Ball Valve

ANSI 150 / ANSI 300
Fire Safe to API 607
ISO 5211 Mounting Pad
Anti-Static Device
Blow-out-proof Stem
Standard Port
Body: S.S. / C.S.
Size: 1" - 8"



2-PC Ball Valve

ANSI 150 / ANSI 300
Fire Safe to API 607
ISO 5211 Mounting Pad
Anti-Static Device
Blow-out-proof Stem
Full Port
Body: S.S. / C.S.
Size: 1/2" - 8"
Lockable Handle (Optional)



3-PC Ball Valve

Fire Safe to API 607
2000 PSI / Class 800
Bolt Enclosed Type
Ends: SE / BW / SW
ISO 5211 Direct Mounting Pad
Anti-Static Device
Blow-out-proof Stem
Full Port
Body: S.S. / C.S.
Size: 1/2" - 8"
Lockable Handle (Optional)



2-PC / 3-PC Trunnion Ball Valve

Design: API 6D, API 608, ISO 5211
Fire Safe to API 607 / API 6FA
Type: Cast / Forged
Double Block and Bleed design with option:
Emergency Sealant Injection System
Size: 2" - 60"
Class: 150# to 1500#
Body: C.S. / Low temp C.S. / S.S.
Trim: C.S. + ENP / S.S.
Seat / Seal: PTFE / Devlon / HNBR / Buna
NACE Compliant



Forged Steel Valve

Design: API 602, ASME B16.11
ASME B16.34, MSS SP-25
Class: 800# / 1500# / 2500#
Body: S.S.(A182 F316, F316L) /
C.S. (A105N)
Size: 1/2" - 3"
Available in Globe, Gate, Check
Connection: Socket Weld, Butt Weld
Screw End (NPT), Flange End
Service: Standard, Extended Bonnet,
Cryogenic



Butterfly Valve

Design: Wafer / Lug Type
ANSI 150 / JIS 10K / DIN PN10 / PN16
Seat: NBR / EPDM / VITON / PTFE
Body / Disc: Cast Iron / S.S. / C.S.
Operator: Lock Lever, Worm Gear
Size: 2" - 24"



Y Spring Check / Y Globe Valve

Working pressure: 200 / 600 PSI
Screwed Ends
Body: S.S.
Size: 1/4" - 2"



Needle Valve (High Pressure)

Working pressure: 6000 PSI
Screwed Ends
Body: Investment Cast S.S. / C.S.
Size: 1/4" - 1"



Automated Valve

Operation: Pneumatic / Electric
Double Acting / Single Acting
Connection: SE / BW / SW / FE
Size: 1/2" (DN15) - 10" (DN250)
Optional: 3/2 or 5/2
Solenoid Valve, Limit Switch Box,
Filter Regulator



Ball Valve (High Pressure)

Class: 1500# / 2500#
Fire Safe to API 607
Ends: SE / BW / SW
Anti-Static Device
Blow-out-proof Stem
Reduced Port
Body: S.S. / C.S.
Seats: PEEK + 15%CF
Size: 1/2" - 2"
NACE Compliant



Cryogenic Ball Valve

1500 PSI
ISO 5211 Mounting Pad
Anti-Static Device
Blow-out-proof Stem
Ends: SE / BW / SW
Full Port
Body: S.S.
Seats: PCTFE (Kel-F)
Size: 1/2" - 2"



3-Way / 4-Way Ball Valve

ANSI 150 / ANSI 300
DIN PN16 / PN40
T-port or L-port (3-Way Ball Valve)
ISO 5211 Direct Mounting Pad
Anti-Static Device (Optional)
Full Port / Reduced Port
Body: S.S. / C.S.
Size: 1/2" - 8"



ESPERO Gate Valve

Application from -20°C to 650 °C
Patented Soft Seat suitable for severe service
Improve Shut-off performance & solution
For Liquid & Slurries use at high temperature
Alternative solution to metal seated options
Size: 2" - 42"
Material available on request

Made in Japan



ESPERO Discharge Valve

Osaka Factory Assembled
Fully Calibrated and leak tested
Material: Hastelloy, Stainless Steel,
Titanium, Carbon Steel
Operation: Handwheel, Gear Box and
Actuator
Size available on request

Made in Japan

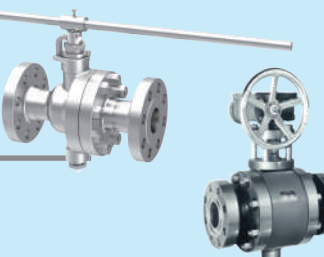

ESPERO Trunnion Ball Valve

Connection: Double Flange, RF, RTJ
Pressure: Up to 10,000 PSI
(API Class 10,000)
Material: Stainless Steel
Traceability: Wetted components are
traceable to original material
certification
Size available on request

Made in Japan



Centric / Eccentric Butterfly Valve

Design: BS EN 593 / API 609
Tested: API 598
Seal Options: Metal Seated / Soft Seated
Size: Up to 72"
Flange End: ASME B16.5 / B16.47 /
EN1092-2 / DIN 2501
Body: WCB / S.S. / Ductile Iron



Knife Gate Valve

Manual / Pneumatic
Ratings: ANSI 150 / JIS 5K or 10K /
DIN PN10 or PN16 / BS standards
Body: WCB / S.S. / Ductile Iron
Design: BS EN 593 / API 609
Tested: API 598
Seal Options: Metal Seated / Soft Seated
Size: 2" - 72"



Penstock, Sluice Gate Valve, Stop Log (ESAREKA)

Material : S.S. / Duplex
Size: Customise size range varying
from 225mm onwards
Style: Channel Mounted / Wall Mounted
Standards: BS, AWWA
Connection: Conforming fully to BS7775
Stem: Rising Stem / Non-Rising Stem
Operation: Handwheel, Gear Box, Actuator

Made in Malaysia



1-PC / 2-PC Ball Valve

1000 PSI / 2000 PSI
Fire Safe to API 607
Reduced Port / Full Port
Blow-out-proof Stem
Body: S.S. / C.S.
Size: 1/4" - 2"
Lockable Handle



3-PC Ball Valve

1000 PSI
Ends: SE / BW / SW / Grooved Ends
Anti-Static Device
Blow-out-proof Stem
Body: S.S. / C.S.
Size: 1/4" - 4"
Lockable Handle (Optional)



3-PC Ball Valve (Fire Safe Design)

Fire Safe to API 607
Ends: SE / BW / SW / OB / FE
DIN PN16 / PN40 / 1000 PSI
ISO 5211 Direct Mounting Pad
Anti-Static Device (Optional)
Blow-out-proof Stem
Full Port
Body: S.S. / C.S.
Size: 1/4" - 4"
Lockable Handle (Optional)



Single / Dual Check Valve

Ratings: ANSI 150 or 300 / DIN PN10 /
JIS 10K or 20K
Body: C.S. / S.S.
For Horizontal or Vertical Lines
Swing Type
Integral Seat Ring for API 603
RF End
Seat Ring Stellite for API 600
Size: 2" - 42"



Check Valve

Ratings: ANSI 150 or 300 / DIN PN16 /
JIS 10K or 20K
Body: C.S. / S.S.
Tested: API 598
For Horizontal or Vertical Lines
Swing Type
Integral Seat Ring for API 603
RF End
Seat Ring Stellite for API 600
Size: 1/2" - 24"



Swing Check Valve

Working pressure: 200 / 600 PSI
Screwed Ends
Body: S.S.
Size: 1/2" - 3"



Globe Valve

Working pressure: 200 / 600 PSI
Screwed Ends
Rising Stem
Body: S.S.
Size: 1/2" - 2"



Gate Valve

Working pressure: 200 / 600 PSI
Screwed Ends
Non rising Stem
Body: S.S.
Size: 1/2" - 3"



Y-Strainer

Working pressure: 200 / 600 PSI
Screwed Ends
Body: S.S.
Size Range: 1/4" - 2"